

- 1 Major junction so inevitably crossing points are and will remain limited
- 2 Too much hard surfacing and a shortage of green 'break out' spaces in busiest part of town
- 3 Uncertain future for the bank building- plan for redevelopment or a new use?
- 4 Where are the cyclists?

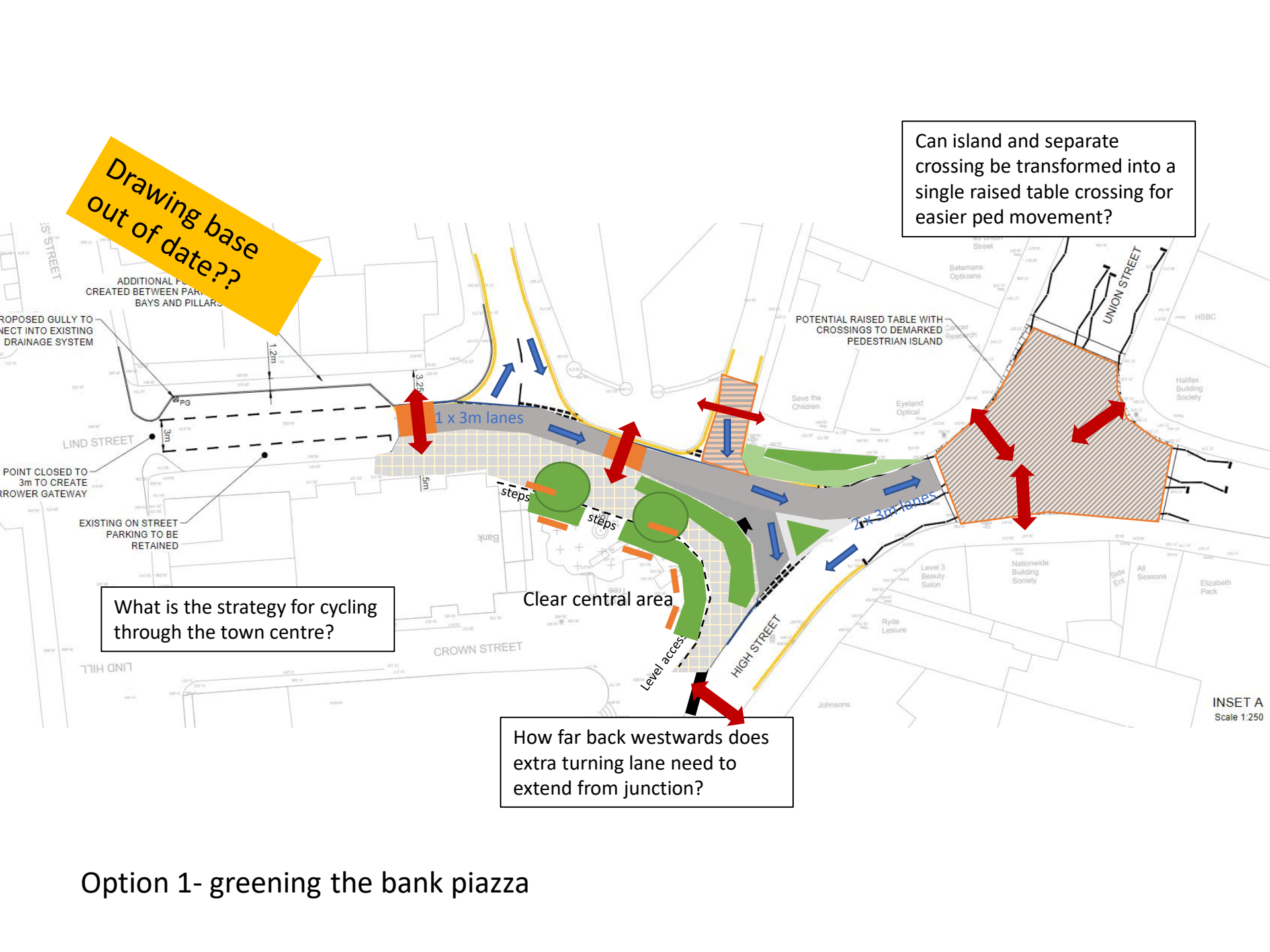

Drawing base out of date??

Can island and separate crossing be transformed into a single raised table crossing for easier ped movement?

What is the strategy for cycling through the town centre?

How far back westwards does extra turning lane need to extend from junction?

Option 1- greening the bank piazza

INSET A
Scale 1:250



Increase planting area by removing inaccessible ped strip beside c'way



Increase planting area by removing inaccessible ped strip beside c'way

Possible planter/feature on enlarged island?



Can island and separate crossing be transformed into a single raised table crossing for easier ped movement?

Can island and separate crossing be transformed into a single raised table crossing for easier ped movement?

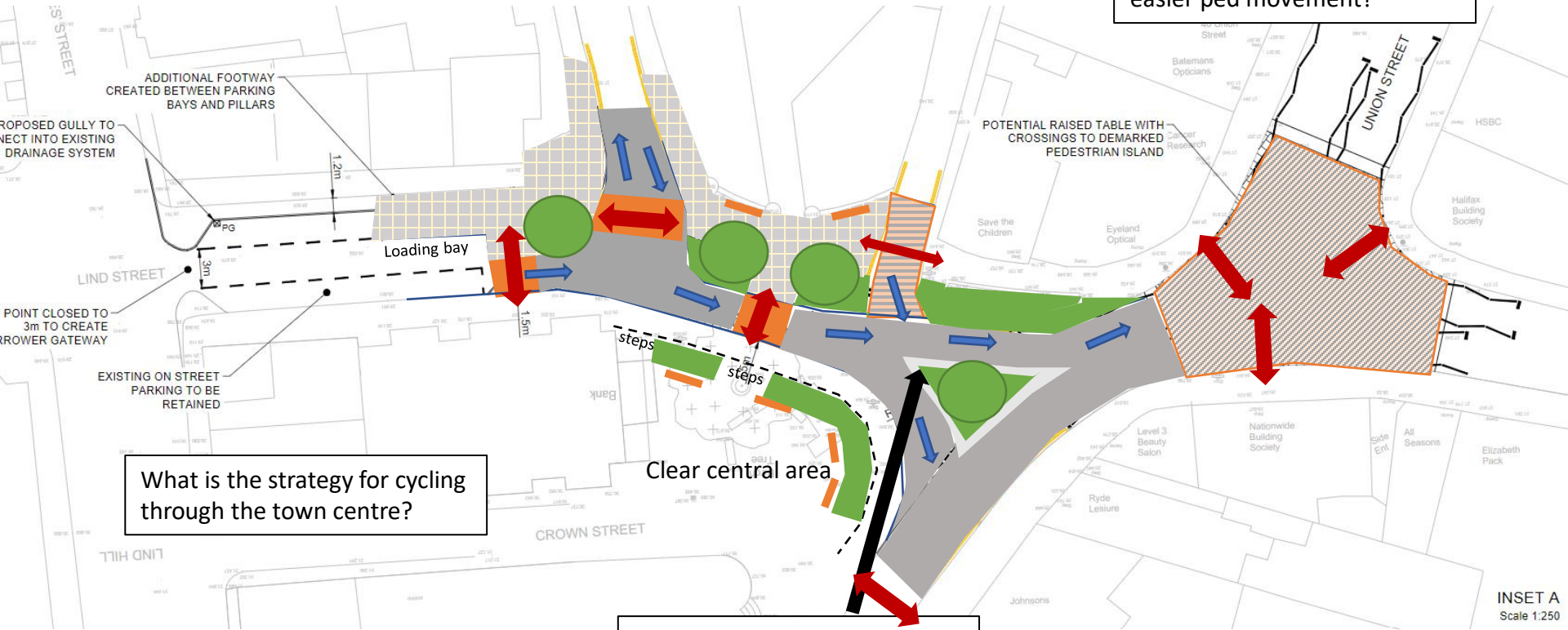

What is the strategy for cycling through the town centre?

How far back westwards does extra turning lane need to go from junction?

Option 2- improve ped flow on north side & introduce planting