

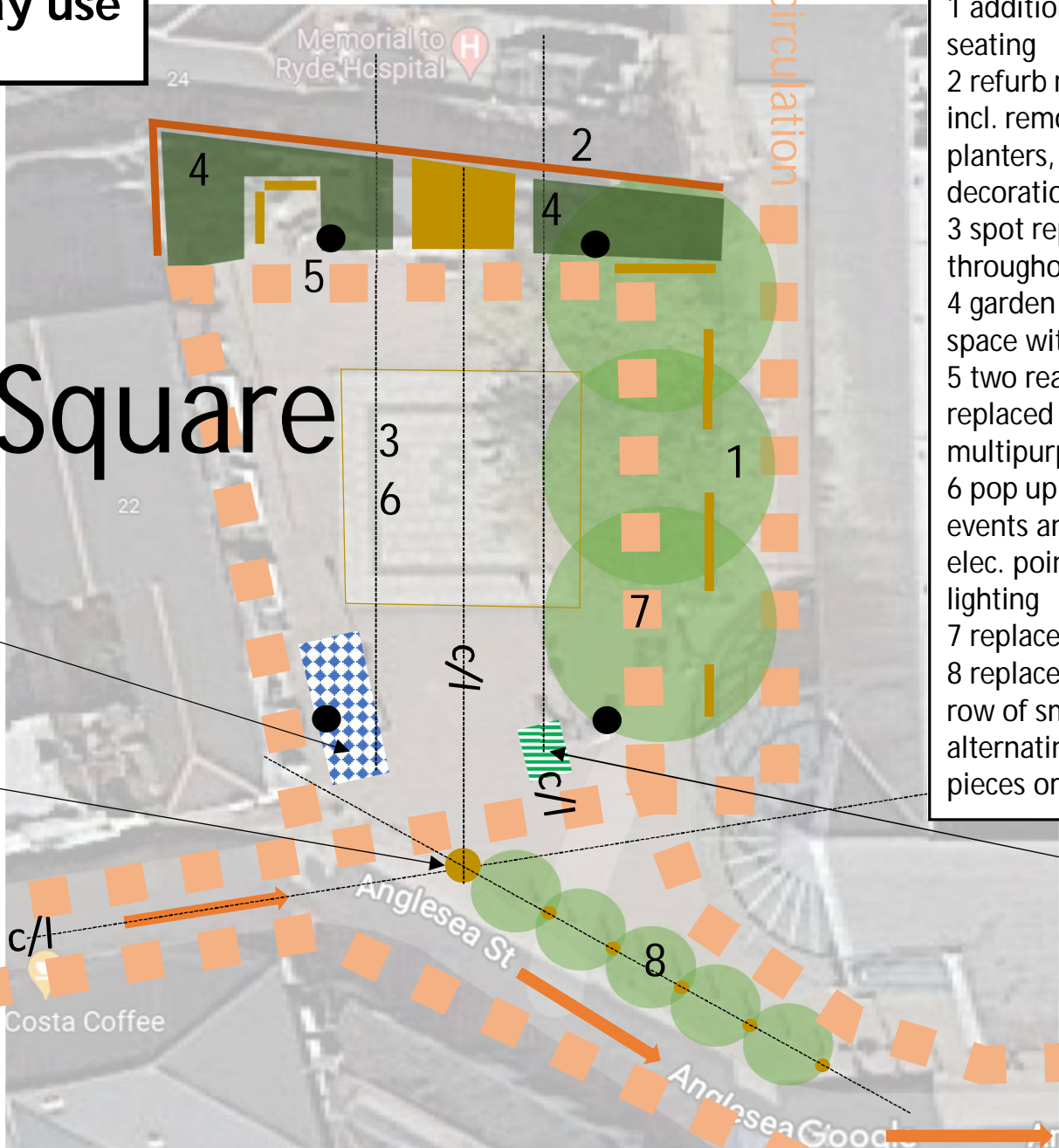

Every day use

Town Square



- Priority improvements:
- 1 additional/replacement seating
 - 2 refurb rear wall and plaques incl. removal wall-mounted planters, spot repairs and re-decoration
 - 3 spot repairs to paving throughout
 - 4 garden beds to rear of space with sensory planting
 - 5 two rear lighting columns replaced or adapted to suit multipurpose use of space
 - 6 pop up service column/s for events and markets plus elec. points for festival lighting
 - 7 replace missing tree
 - 8 replace line of bollards with row of small ornamental trees alternating with sculptural pieces or seats

licensed tables and chairs (Pancake House)

feature seat/eyecatcher

One off traders- coffee van, ticket sellers, promotions, charity stalls etc. close to Anglesea Street

vehicles
ped circulation

ped circulation



Markets

ped circulation

smaller stalls with access for vehicles to drop off and park up elsewhere

communal tables and chairs for foodie markets, set out to allow for some shade

larger food trucks/vans closest to Anglesea St

Town Square

licensed tables and chairs (Pancake House)

c/l

vehicle access as existing with turning area left clear in central space

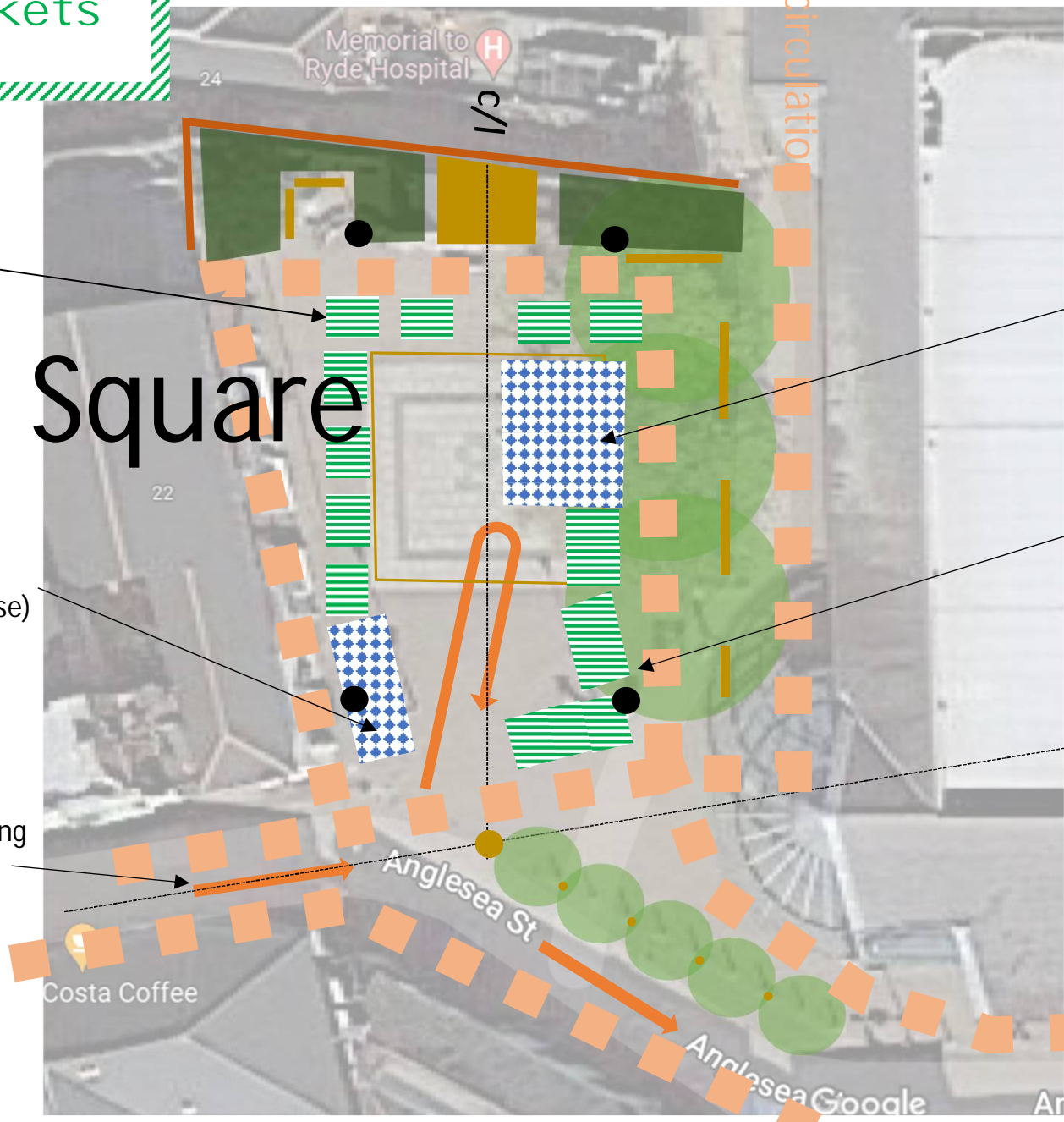



Town Square

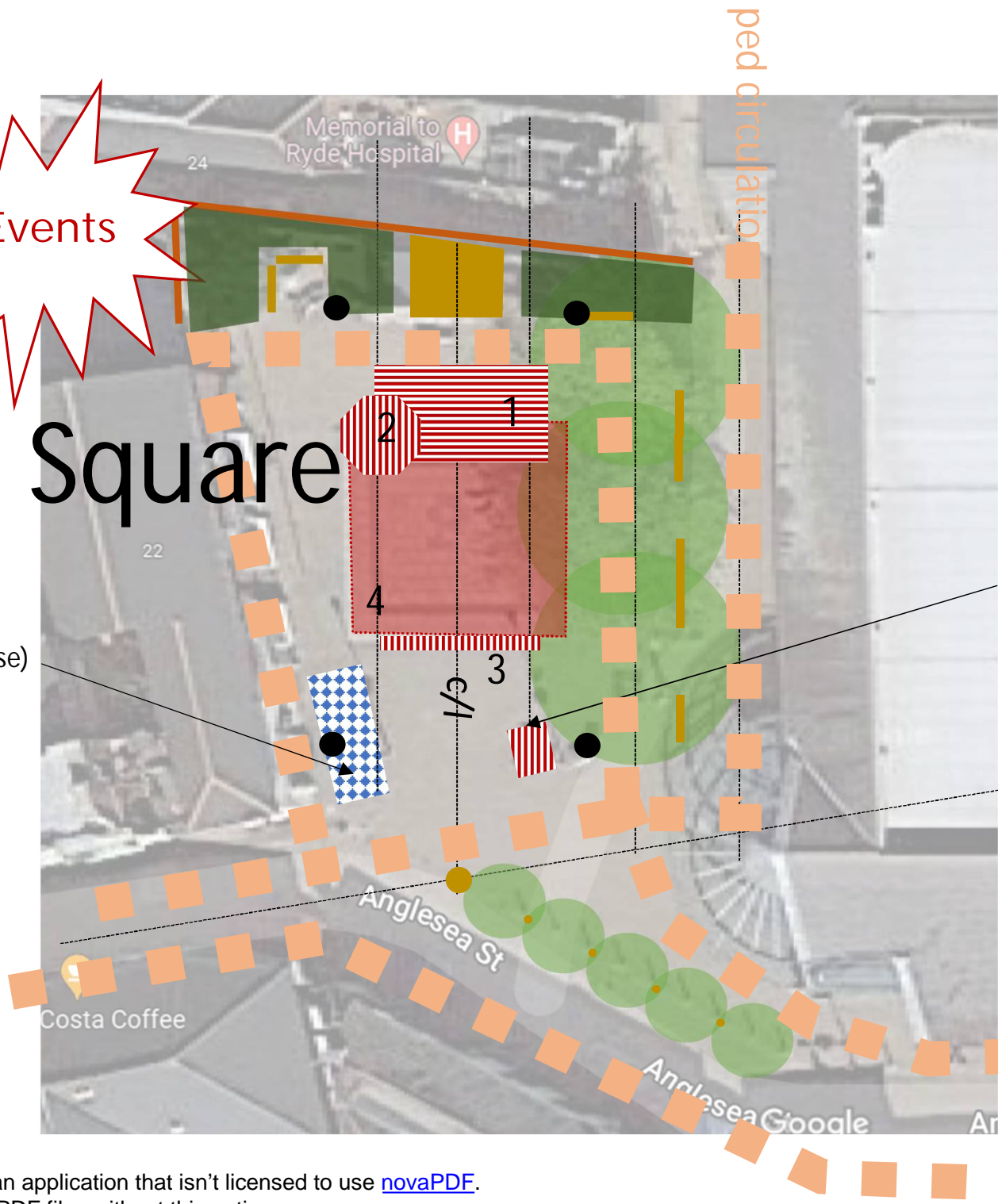

- Alternative positions for:
- 1 covered stage
 - 2 bandstand
 - 3 screen
 - 4 children's fair

licensed tables and chairs (Pancake House)

Entry kiosk, tickets, first aid etc.

c/l

ped circulation

Opportunities for Artists

Town Square

- ...include:
- 1 additional plaques on rear wall and interpretation
 - 2 decorative end rondels to off-the-peg seats or custom design
 - 3 painted pavement art or cast inserts in central area
 - 4 lighting displays / installations
 - 5 feature seat / eyecatcher and surround potentially interactive with light and sound
 - 6 'bollards' or seats/perches
 - 7 makers/crafters fairs and demos

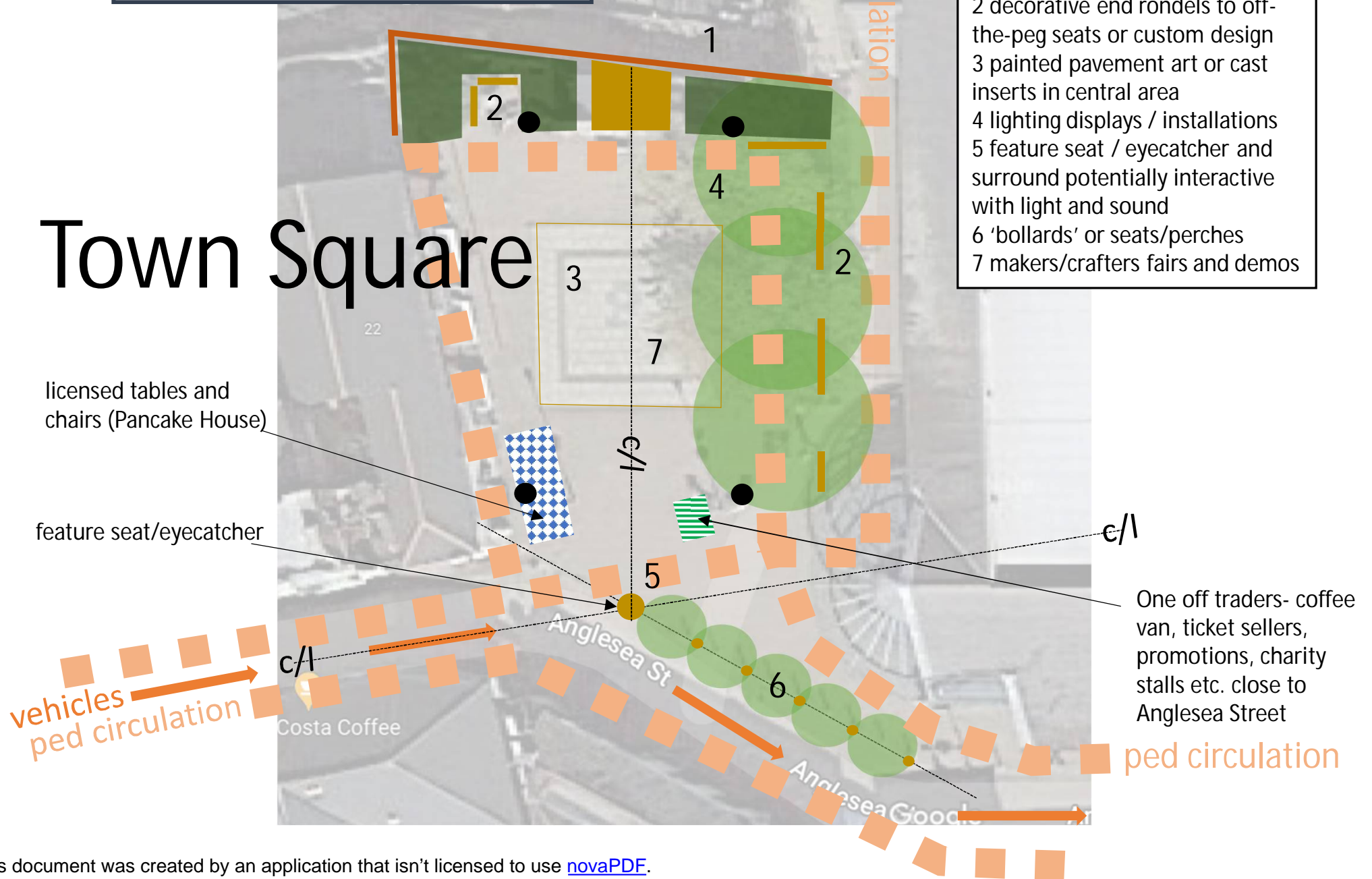

N



Clear route through across square at both ends

retain existing trees

feature seating/ sculptural pieces

Retain two seats at west end and add planters beside/behind

area for licensed tables and chairs (Fish and Chip shop)

Priority improvements:

- 1 remove central seats to leave central space clear
- 2 pop up service column
- 3 Retain Xmas tree socket and service
- 4 additional planters along western edge

area for licensed tables and chairs (Castle Inn)

ped circulation

Minghella Square

